

BE 20T

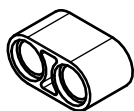

BE 3 OT

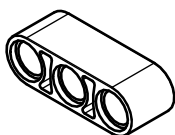

BE 50T

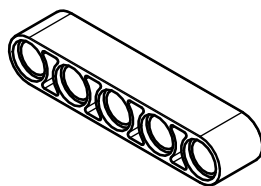

BE 70T

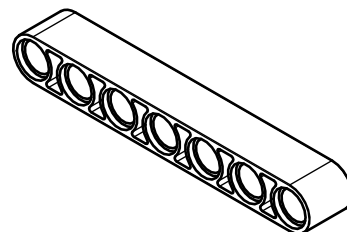

BE 90T

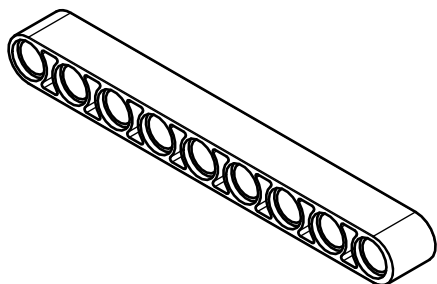

BE 150T

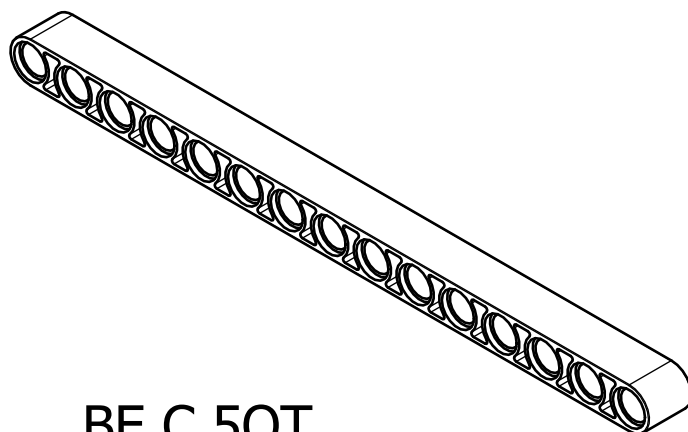

BE C 60T

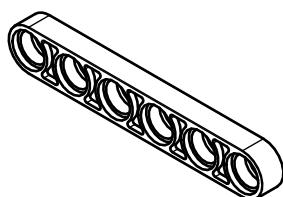

BE C 50T

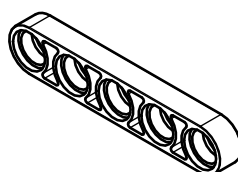

BE C 20T 2KR

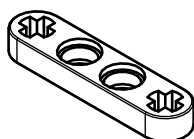

BE C 10T 2KR

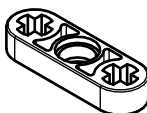

BE C 2KR

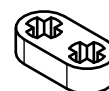

Projektował: Łukasz Rębisz	2013-02-19	Podziałka:	Materiał:	Masa:
Rysował: Łukasz Rębisz	2013-02-19	1:1		Nie dotyczy
Sprawdził:		Podpis:	Format:	Arkusz:
Zatwierdził:			A4	1 / 1
Politechnika Rzeszowska im. Ignacego Łukasiewicza Wydział Budowy Maszyn i Lotnictwa Katedra Konstrukcji Maszyn		Nazwa części: BELKI		
		Nr normy lub rysunku: Klocki		